

ENGINEER TO ORDER

SPECIAL PROJECT INFORMATION SHEET



Project Description	Extended Torque Reactions to fit PTM-72-1000		
Date created	11 July 2012	Project Number	Q2464 + Q2465

INTRODUCTION & APPLICATION

Torque reactions required with additional reach and span to standard item fitted to PTM-72-1000.

SOLUTION

Special fabricated steel torque reactions.

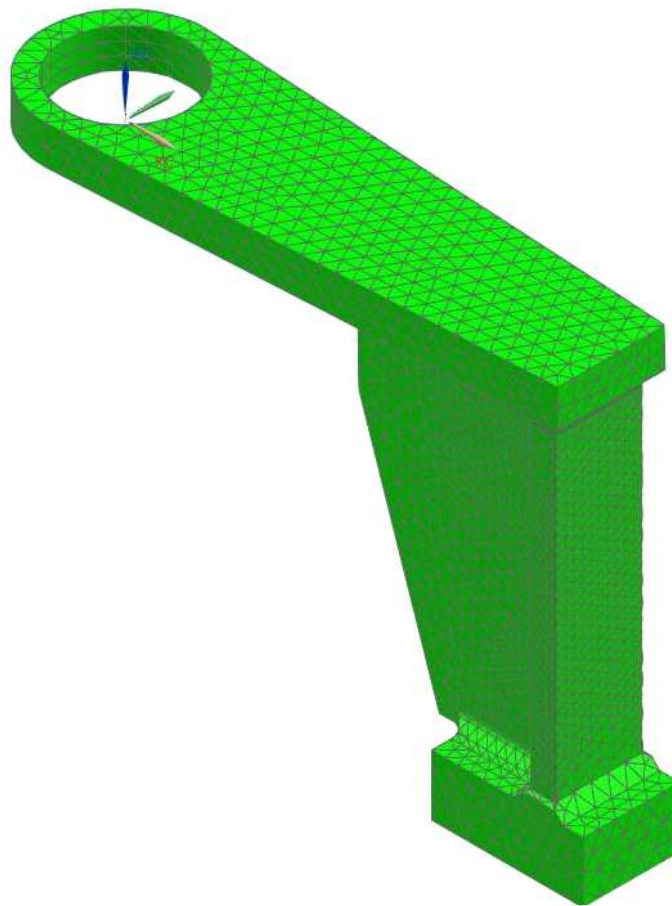

TECHNICAL SPECIFICATION / DATA HIGHLIGHTS

Q2464 – 219mm reach forward from reaction mounting face / 250mm span from tool axis
Q2465 – 179mm reach forward from reaction mounting face / 210mm span from tool axis
Standard PTM-72-1000 - 99mm reach forward from reaction mounting face / 165mm span from tool axis
Finite Element Analysis used to verify suitability for 1,000 N.m maximum torque.